

Description of Proposed Emergency Temporary Road Closure – Flexford Road and Nutburn Road, North Baddesley

Description: temporary closure of part of Flexford Road and Nutburn Road to allow safe access to undertake urgent carriageway repair works. This would effectively mean that there is no access to both roads from Pound Lane.

Location: Flexford Road and Nutburn Road for a distance of 200 metres either side of their junction with Pound Lane.

Alternative routes: Northwards on Pound lane to A3090, west and then south along the A3090, south on Haltherworth Lane, east and then south on Highwood Lane, further south on Botley Road, south east on A27 Botley Road, further east on Castle Lane, north on Knightwood Road, west on Flexford Road to the eastern point of closure and on the same roads in the opposite direction. A plan of the diversion route is included on the following page.

NOTE: the 7.5T weight limit on Botley Road will be temporarily suspended during the closure

Duration of Order: from 20 September 2016 for a period of five days or until completion of the works whichever is sooner.

Period of Works: Notwithstanding the above it is expected that the closure will be required for no longer than 2 days and to be completed by 18:00 on 21 September.

Reasonable access to adjoining properties will be maintained while the work is going on.

If you have any queries regarding the above works, access or alternative route please contact Mr Steve Elefthriou on behalf of Hampshire County Council Highways 0300 555 1388. For other queries please contact Mr Ejikeme Ibe, telephone 01264 368728 on behalf of the Head of Planning Policy & Transport Service.

Parish, Borough and County Ward Members

Parish Council(s)	North Baddesley
Borough Member(s)	North Baddesley
County Member(s)	Baddesley

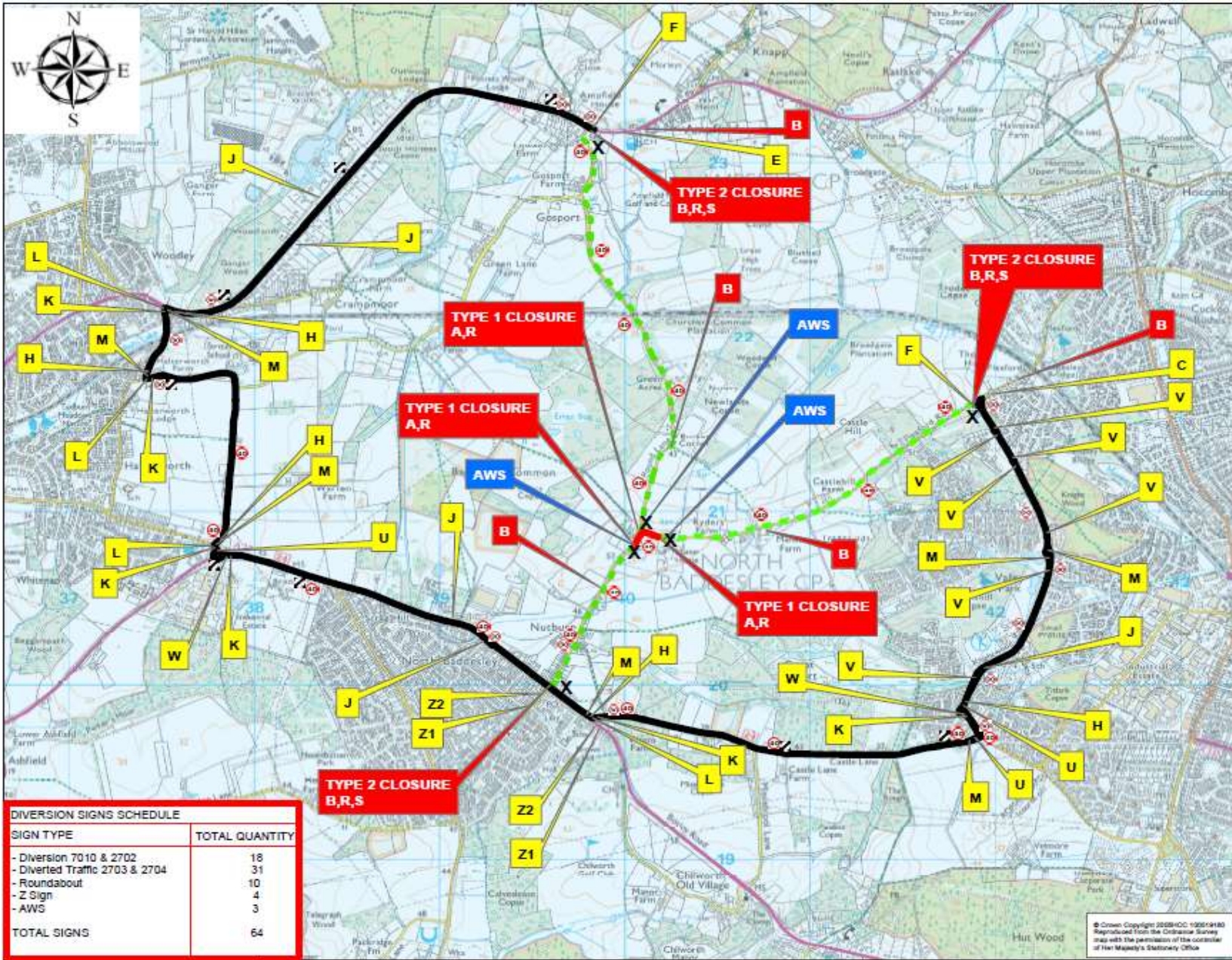

DIVERSION SIGNS SCHEDULE	
SIGN TYPE	TOTAL QUANTITY
- Diversion 7010 & 2702	18
- Diverted Traffic 2703 & 2704	31
- Roundabout	10
- Z Sign	4
- AWS	3
TOTAL SIGNS	64

NOTES

1. TRAFFIC MANAGEMENT
 a. All traffic management shall comply with the Traffic Signs Manual Chapter 8 2009
 b. Works will be carried out under a Road Closure Type 1

2. CLOSURE POINTS & GATEMEN
 All closure points shall refer to OP RES-001. Gatemen or pedestrian marshalls shall be shown as an "X"

MAXIMUM NUMBER OF GATEMEN REQUIRED FOR SCHEME - 6

3. ADVANCE WARNING SIGNS
 Advance warning signs are to be erected on site two weeks prior to works commencing. Sign to read:



4. RESTRICTED HOURS
 The works on site are restricted to between 09:30hrs - 16:00hrs

5. DIVERSION SIGNS KEY
 For standard diversion signs refer to list to the right.

6. SPEED LIMIT
 Speed limit is 40 mph on site. Other limits are shown throughout the route.

7. SCHEME INFORMATION SIGNS
 HCC scheme sign boards to Drg No HCC/C/145 type 1 or 2 to be erected on site 2 weeks prior to the works commencing and are to remain throughout the duration of the works. Signs are to be removed approximately 1 week after completion of works and taken to store off site.

8. SPECIAL SIGNS, Z1, Z2
 X height for the special signs for roads speeds of: Upto 40 mph = 62.5 or 75 (x-height) to be in accordance with Traffic Signs Manual Chapter 8 2016.

- A ROAD CLOSED
- B ROAD AHEAD CLOSED
- C Diversion
- D Diversion
- E Diversion
- F Diversion Ends
- G Diversion 0 yds
- H Diverted Traffic
- J Diverted Traffic
- K Diverted Traffic
- L Diverted Traffic
- M Diverted Traffic
- N Diverted Footpath
- P Diverted Footpath
- Q
- R
- S ACCESS ONLY
- T
- U DIVERTED TRAFFIC
- V DIVERTED TRAFFIC
- W DIVERTED TRAFFIC
- X DIVERTED TRAFFIC
- Y BUSINESS AS USUAL
- Z

